



ETC Installation Guide

Selador Desire® Series D40/D60 XTI Half Shield

The Half Shield is used to provide glare control at specific angles to either the D40XTI or the D60XTI fixture.

-  **WARNING:** Do not use the fixture with a damaged power lead. If the power lead (cord set) is damaged, it must be replaced.
- Do not expose the interior of the fixture to moisture. Do not stand in water while installing or servicing the fixture.
- Failure to follow these warnings can result in serious injury or death.

Installation

-  **CAUTION:** Do not use the fixture if glass lens is deeply scratched or cracked. Damaged lenses must be replaced.
- Do not mount the fixture on or near combustible surfaces.

The Half Shield can be mounted in four positions on the front of the trim ring of the DXTI fixture. It can also be combined with the secondary lens kit. The Half Shield is installed with the four existing stainless steel screws that secure the trim ring. See the *Desire Series D40/D60 XTI Installation Guide* and the *Desire Series D40/D60 XTI Secondary Lens Installation Guide* for information on electrical requirements and installing the fixture. ETC documentation is available for download at etconnect.com.

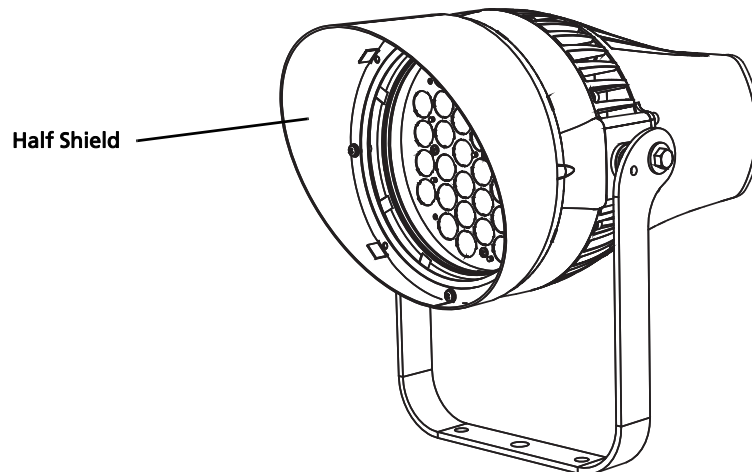

Corporate Headquarters ■ Middleton, WI, USA ■ Tel +608 831 4116 ■ Service: (Americas) service@etconnect.com

London, UK ■ Tel +44 (0)20 8896 1000 ■ Service: (UK) service@etceurope.com

Rome, IT ■ Tel +39 (06) 32 111 683 ■ Service: (UK) service@etceurope.com

Holzkirchen, DE ■ Tel +49 (80 24) 47 00-0 ■ Service: (DE) techserv-hoki@etconnect.com

Hong Kong ■ Tel +852 2799 1220 ■ Service: (Asia) service@etcasia.com

Web: etconnect.com ■ © 2017 Electronic Theatre Controls, Inc.

Product information and specifications subject to change. ETC intends this document to be provided in its entirety.

7410M2120 ■ Rev C ■ Released 2017-02

ETC Installation Guide

D40/D60 XTI Half Shield

To install the Half Shield:

- 1: Using a #2 Phillips screwdriver remove the four trim ring screws.
- 2: Face the shallow side of the shield toward the object you are lighting, positioning the tallest side of the shield so it provides glare control away from the lighted object.
- 3: Align the Half Shield with the four mounting holes on the trim ring.
- 4: Secure the Half Shield with the four trim ring screws.

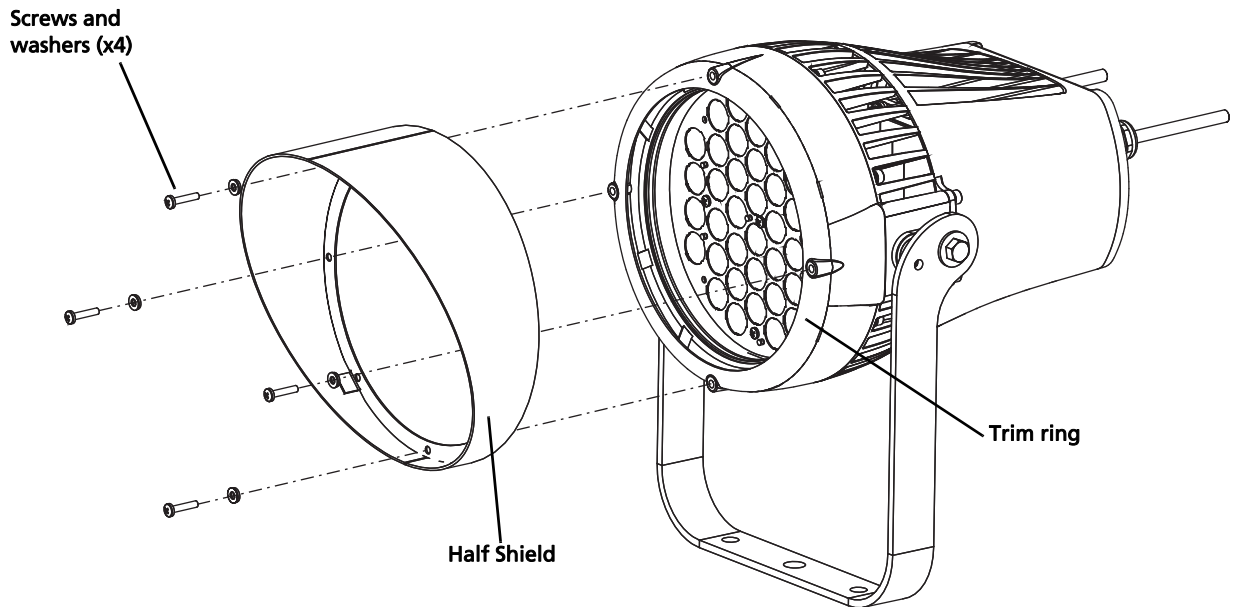

Note: *The Half Shield is installed on top of the trim ring using the existing set of screws.*
