

# ETC Install Guide

## Source Four® LED Fresnel Adapter

### Overview

The ETC Source Four LED Fresnel Adapter is an attachment that installs on the front end of any Source Four LED light engine. This document describes the installation of this attachment.



**WARNING:** The Source Four LED Fresnel Adapter is not compatible with Source Four incandescent fixtures. Use with incandescent fixtures will result in equipment failure.

### Installation Instructions

#### Tools required

- #2 magnetic Phillips screwdriver

#### Disassemble the Source Four LED



**WARNING:** Disconnect power to the fixture before disassembling. Removing the shutter barrel exposes bare contacts that may cause electric shock if encountered.

- 1: Remove the lens tube from the fixture and store in a safe location.
- 2: Remove the shutter barrel:
  - a: Remove the small screw and store in a safe location for future shutter barrel installation. You will not need the small screw for Fresnel installation; a longer screw has been provided with the Fresnel Adapter.
  - b: Remove the barrel screw and set aside.
  - c: Rotate the barrel counterclockwise until it easily slides off of the light engine.

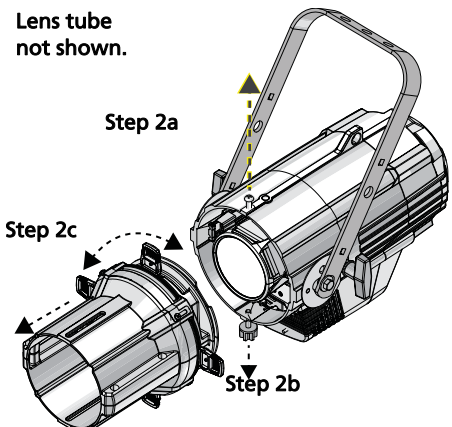

#### Install the Source Four LED Fresnel Adapter

- 1: Confirm that the locking mechanism on the Fresnel Adapter is in the unlocked position.
- 2: Align the rods on the Fresnel Adapter so they slide along the outside lower edge of the fixture body, just below the yoke.
- 3: Slide the Fresnel Adapter onto the fixture body until nested firmly in place.
- 4: Note the lock/unlock image on the Fresnel. Rotate the Adapter lever to the lock position securing the Adapter in place.
- 5: Locate the screw that has been provided with the Fresnel Adapter.
- 6: Using a magnetic screwdriver, insert the screw into the screw hole on the top edge of the fixture and tighten.
- 7: Insert and tighten the barrel screw on the bottom edge of the fixture closest to the light engine.

To watch a demonstration of the Source Four LED Fresnel Adapter installation, go to:

<https://youtu.be/Opla1aGM774>



Corporate Headquarters ■ Middleton, WI, USA ■ Tel +608 831 4116 ■ Service: (Americas) [service@etcconnect.com](mailto:service@etcconnect.com)

London, UK ■ Tel +44 (0)20 8896 1000 ■ Service: (UK) [service@etcurope.com](mailto:service@etcurope.com)

Rome, IT ■ Tel +39 (06) 32 111 683 ■ Service: (UK) [service@etcurope.com](mailto:service@etcurope.com)

Holzkirchen, DE ■ Tel +49 (80 24) 47 00-0 ■ Service: (DE) [techserv-hoki@etcconnect.com](mailto:techserv-hoki@etcconnect.com)

Hong Kong ■ Tel +852 2799 1220 ■ Service: (Asia) [service@etcasia.com](mailto:service@etcasia.com)

Web: [etcconnect.com](http://etcconnect.com) ■ © 2017 Electronic Theatre Controls, Inc.

Product information and specifications subject to change. ETC intends this document to be provided in its entirety.

7460M2140 ■ Rev B ■ Released 2017-02

# ETC Install Guide

## Source Four LED Fresnel Adapter

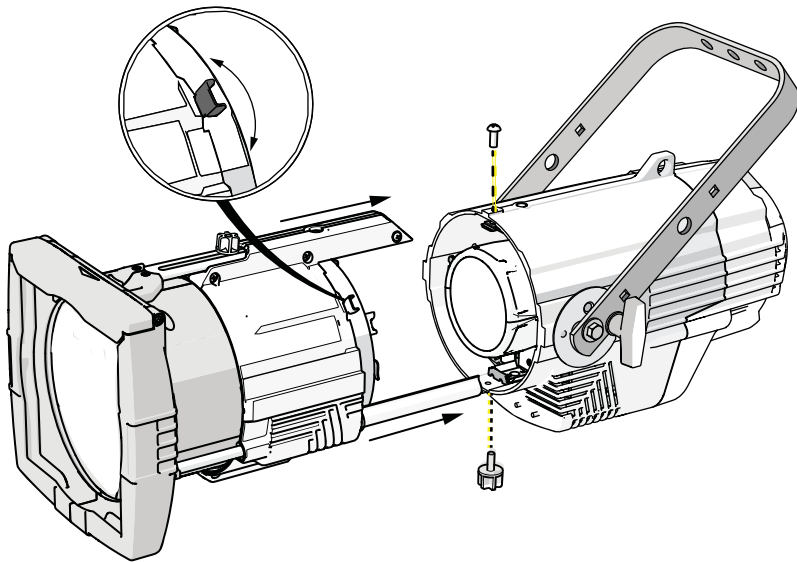

### To remove the Fresnel Adapter:

- 1: Using a magnetic screwdriver, remove the top screw.
- 2: Remove the barrel screw.
- 3: Unlock the Adapter by rotating the gray Adapter lever towards the unlock icon.
- 4: Slide the Adapter off of the light engine.

### Focus

The body of the Fresnel Adapter is adjustable by loosening the top barrel knob and sliding the Fresnel Adapter either away from or towards the light engine.

- Sliding the Adapter out and away from the light engine decreases the size of the beam.
- Sliding the Adapter in and closer to the light engine increases the size of the beam.

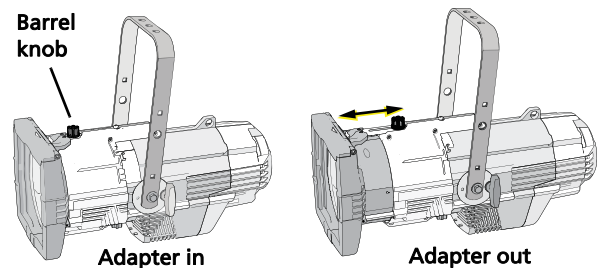

Once focus is complete, retighten the barrel knob to secure the Fresnel Adapter in place.

### Accessory Holder

The top flap of the 7.5" accessory holder is hinged and marked with a silver arrow. Directly behind this arrow is a release button.

To access the accessory slot, depress the release button with your thumb while pulling up gently on the flap, located directly in front of the silver arrow.

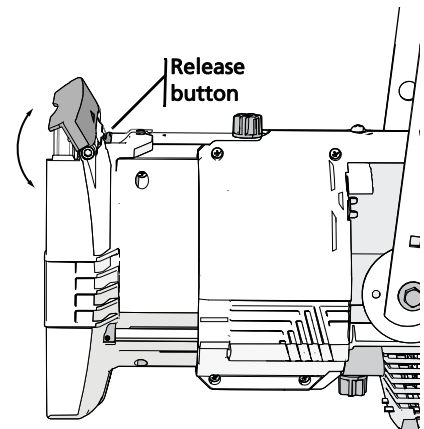

**CAUTION:** *The LED fixture with Fresnel Adapter must be hung with the accessory slot door facing up. When possible, secure any installed accessories with their own safety cable.*

### Cleaning

Using a soft cotton or micro fiber cloth and a 50/50 mix of water and isopropyl alcohol, gently wipe the Source Four LED Fresnel components clean.



**CAUTION:** *Do not use paper towel for cleaning as it may cause scratching.*