

CDDL YA12B

YOKE ASSEMBLY FOR CDD-LIVE12 AND XD12

Features

- Ceiling, truss or wall mount for CDD-LIVE12 and XD12
- Landscape (ceiling/truss mount) or Portrait (wall mount) configuration.
- 360° vertical adjustment in landscape mode (ceiling/truss mount)
- 360° horizontal adjustment when ceiling/truss mounted from central point
- 360° horizontal adjustment when wall mounted (portrait mode only)
- Rubber spacer supplied for use with XD12
- Handwheel adjustment for portable applications
- Hex bolt adjustment for installed systems



Applications

- Portable and installed CDD-LIVE12 and XD12 systems

Contents

- 1 x CDD-LIVE12/XD12 Yoke top frame
- 1 x CDD-LIVE12/XD12 Yoke bottom frame
- 1 x XD12 Rubber spacer
- 1 x M8x30 Handwheel
- 1 x M8x40 Hex Bolt
- 2 x M8x70 Cap head hex bolt
- 3 x M8 Plain washer
- 1 x M8 Spring washer

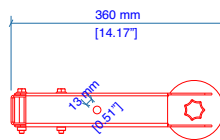

CDDL YA12B

CDD-LIVE12/CD12 FLYING YOKE

Technical Specifications

| | |
|-----------|---------------------|
| Weight: | 7.2kg (15.87lb) |
| Material: | Powder coated steel |

